

Included Parts:

1. TRIAC with wire leads
2. Zip ties

Required Tools:

3. #2 Phillips Screwdriver
4. Allen Wrenches (3/32" & 9/64")
5. Scissors



CAUTION: Detach power cord before proceeding



Lower heater but do not lock into place, such that it rests gently on lower platen



Loosen set screw in shaft of pressure adjustment knob and remove knob using 3/32" Allen Wrench

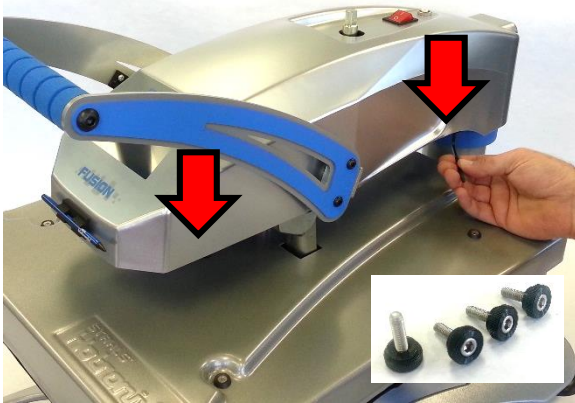

Remove 4 #8-32 x 1/2" Thumb Screws (right 2 shown) from underside of control housing using 9/32" Allen Wrench

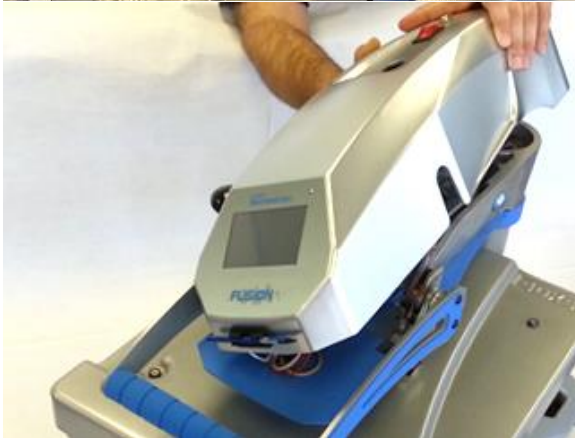

Lift off control housing and lay it gently on left side of press

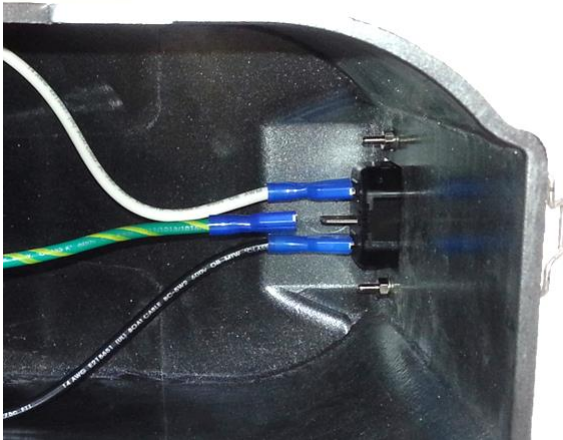

Unplug ground wire (green with yellow stripe) from IEC inlet at rear of housing

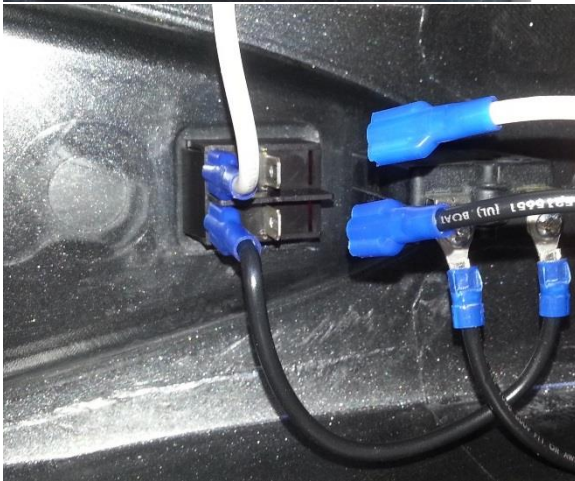

Unplug Black & White wires from Power Switch as shown to disconnect from Controller

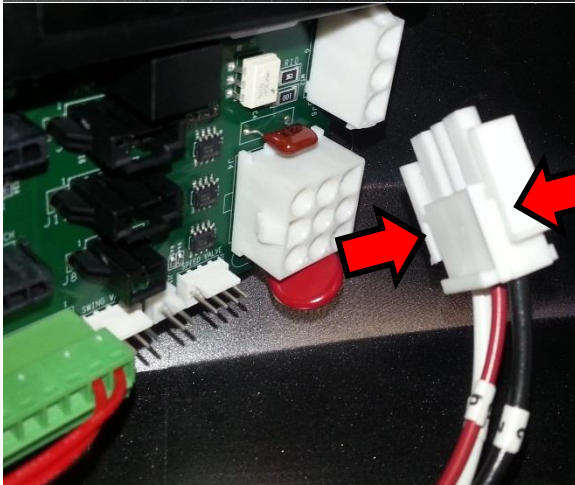

Unplug 3-pin TRIAC connector from Controller by squeezing sides to release locking clips

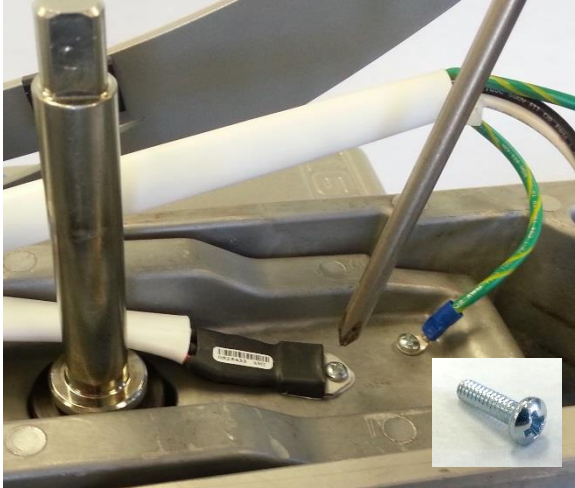

Remove TRIAC using #2 Phillips
Screwdriver, saving #6-32 x 1/2" screw

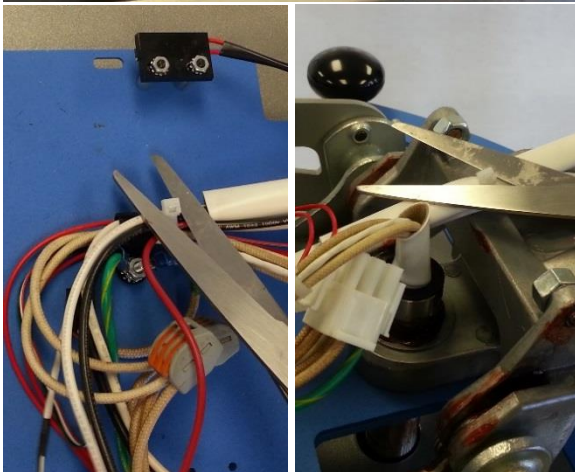

Cut zip ties holding TRIAC wires using
scissors or wire cutters, careful not to
damage press wiring

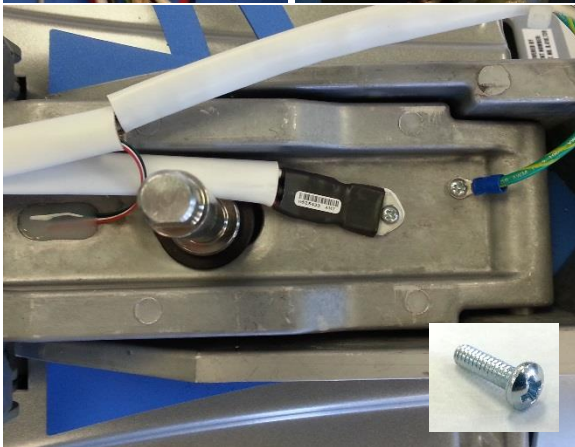

Install TRIAC flat side down using existing
#6-32 x 1/2" screw, orienting it to direct wires
around adjustment spindle and towards front
of press as shown

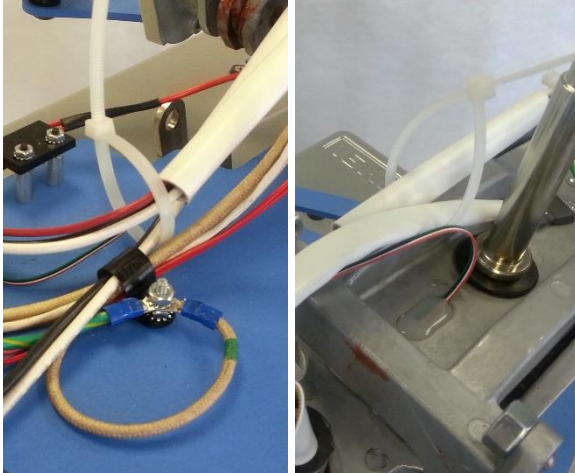

Install 2 Zip-Ties to secure cables, being sure to exclude Strain Gauge cable as shown

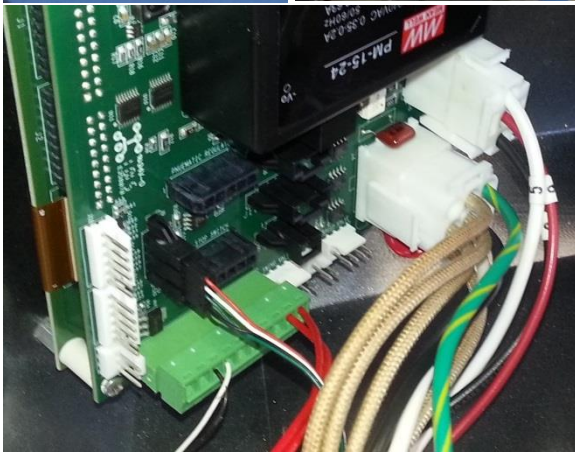

Plug 3-pin TRIAC connector into Controller

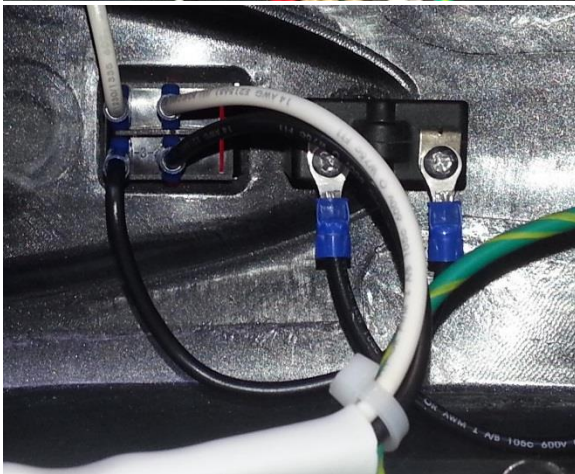

Plug in White & Black wires into Power Switch on opposite sides of the divider as shown to connect to Controller

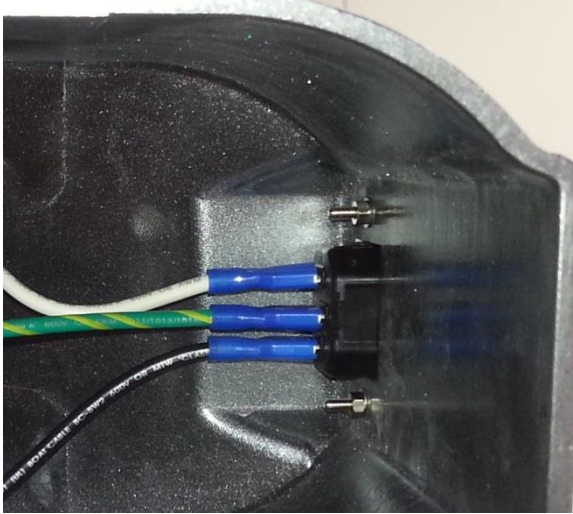

Plug Green wire with Yellow band into IEC outlet to connect to grounding circuit

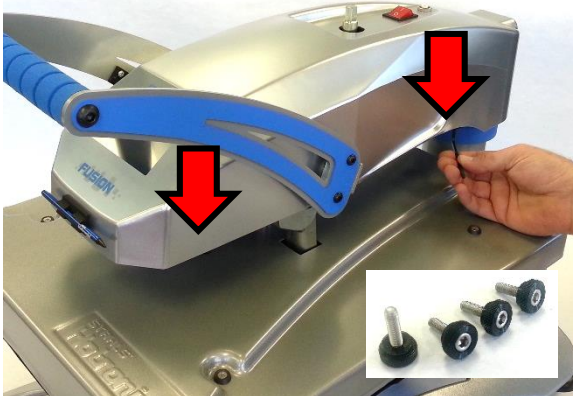

Replace housing onto press and insert 4 #8-32 x 1/2" Thumb Screws (right 2 shown), tightening with 9/32" Allen Wrench



Replace Pressure Adjustment Knob, aligning set screw with flat of shaft and tightening with 3/32" Allen Wrench



Raise handle into open position, plug in
press and turn ON to verify proper operation